

Where does the water come from?

1 The average home produces approximately 400 gallons of wastewater daily.

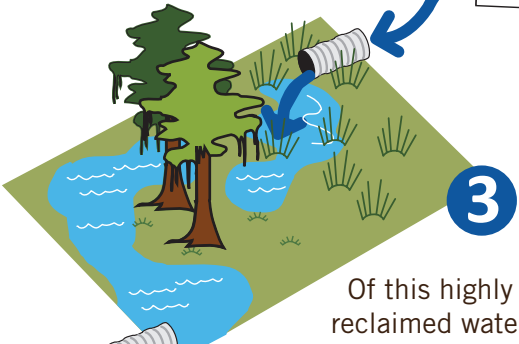
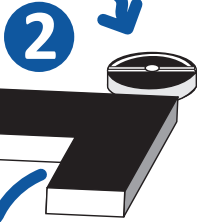
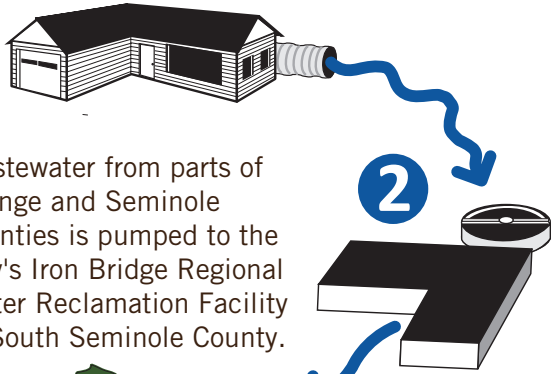

3

Of this highly treated reclaimed water, up to 35 million gallons a day are sent to the 1,200 acre man-made wetlands where aquatic plants further remove nutrients.

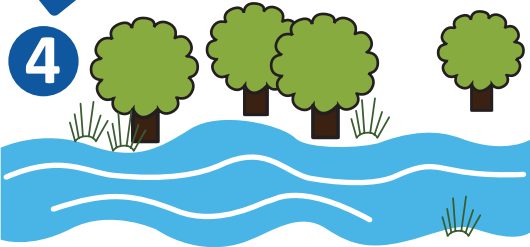

4

It takes approximately 40 days for the reclaimed water to filter through man-made marshes before reaching the St. Johns River.

Facts

- Orlando Wetlands Park represents the first large scale man-made wetland designed to treat reclaimed water and provide wildlife habitat.
- The wetlands began receiving flow from the Iron Bridge Regional Water Reclamation Facility in July 1987.
- Nineteen miles of berms were built to create 18 wetland cells, and 67 water control structures were incorporated into the system. A 75-acre lake was created to provide fill for the berm construction.



- Today the wetland system provides habitat for numerous animal species, including over 200 bird species, otters, foxes, deer, turtles, snakes and alligators.
- Over 2 million aquatic plants and 200,000 trees were planted to create the wetlands.
- Oyler Overlook is an earthen mound created from thousands of yards of muck and cattails. The mound is approximately 30 feet tall and gives visitors an outstanding view of the surrounding wetlands.



About Orlando Wetlands Park

Orlando Wetlands Park is open to the public for nature study and peaceful enjoyment. Recreational activities include walking, jogging, bird watching, wildlife appreciation, nature photography and bicycling.

Directions:

Drive 40 minutes east of downtown Orlando on State Road 50 to Christmas, Florida. Go north (left) 2.3 miles on Ft. Christmas Road (County Road 420) and 1.5 miles east (right) on Wheeler Road. Parking will be on your left.

Hours:

Sunrise to sunset, seven days per week

FREE ADMISSION



Orlando Wetlands Park

25155 Wheeler Road, Christmas, FL 32709

407.568.1706

cityoforlando.net/wetlands

Please call or visit the park's website for more information on nature programs or group tours.



CITY OF ORLANDO

PUBLIC WORKS DEPARTMENT

WASTEWATER PROCESS/OPERATIONS

Revised 2/2016

Orlando Wetlands Park

Map & Guide



Photography by Mary Keim

